

Auto Mini Coater

Automatic coating tester



DL-2015AC

Feature

- User friendly (7") color touch LCD show the running status and real temperature graph, precise temperature control by PID.
- Quick dry and equalized temperature distribution by forced convection up & down air flow system.
- Repeatability improvement by sensor system for knife zero-setting.
- Coating knife is consist of Doctor knife (0.5mm - Standard, 1.0mm, 2.0mm - Option) & Comma knife. Another type & thickness of knife is customized.
- The exhaust fan on the roof ventilate to outside the gas of chamber inside.
- Convenient operation with automatic driving mechanism.
- Consistent coating speed and ensures standardized quality.
- Precise coating of 0.01mm(10 μ m) thickness on one side of material.
- Adjustable knife inclination, coating, thickness, speed and distance.



Exhaust fan

When conducting coating experiments, the odor caused by gas generated inside the chamber can be released to the outside to maintain a pleasant environment. (Exhaust duct installation required)



Auto clever door

It is a device for forcibly cooling the high temperature inside the chamber, and can rapidly cool it by operating an actuator to bring in cold air from outside into the chamber.



Control panel (Touch)

Specification

Model	DL-2015AC
Specimen size	330 x 430mm
Working surface size	280 x 300mm
Coating frame	Pin type, Paper & foil type
Coating speed	0.2~5m/min.
Coating head	1 set (Thickness gauge)
Coating knife	Doctor knife, Comma knife (Option)
Coting roller	Embossing type (Option)
Dwell time	1sec.~99min. (User setting)
Pin frame in/out motor	200W (Inverter control)
Circulation fan speed	700~2500r/min.
Circulation fan motor	750W (Inverter control)
Heater	7200W
Temperature range	25~250℃ (Max. 220℃)
Over heat limit	280℃
Power source	380VAC 50/60Hz 3 phase, 8.5kW
Weight (Approx.)	360kg (±5kg)
Dimension (Approx.)	950(W) x 1250(D) x 1650(H)mm

ACCESSORIES

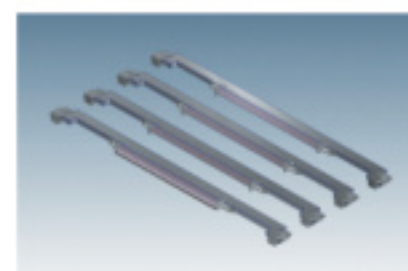

Coating knife (Option)



Coating head

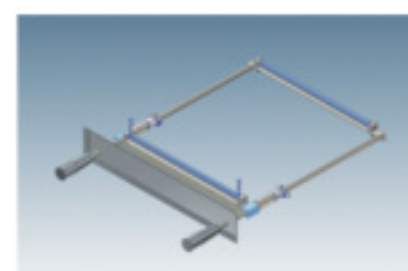

Paper and foil frame

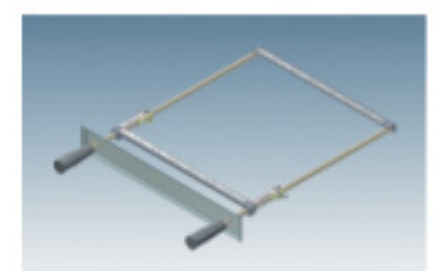

Length pin frame